

Sec. 26, T. 7. N.  
R. 2. W.

Dec. 6-1898.

Lower piece to Jos. W. Evans,  
from David J. Evans.

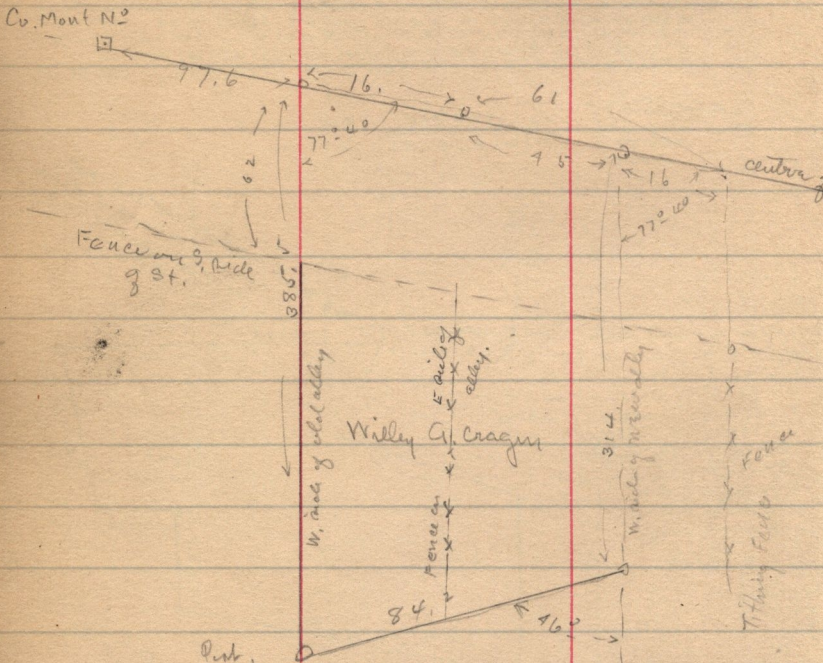

Copy of description entered by self in deed  
from David J. Evans to Wiley G. Cragun,  
Pt. NW 1/4 Sec. 30, Tp. 7-N - R. 1.W., Beg. at  
point.  $7.03$  chs W. and  $35.96$  chs N 1/2 E. of  
SE. Cor. sd. 1/4 Sec. Thence N  $77^\circ W$   $0.95$  ch. -  $51^\circ W$   
 $5.84$  ch. N  $43^\circ 19' E$   $1.24$  chs; N  $1^\circ E$   $47.5$  ch. to Eq.

Rec'd 1/2 onions .45 chs  
chgs 3.00

N-11 - C.W. Thurston to David Evans  
Pt. NW 1/4 Sec. 30 T. 7. N - R. 1. W. -  
Beg.  $287$  ch W. of SE. cor. N  $1^\circ E$   $35.0$   
N  $77^\circ W$   $5.10$  ch. S  $7^\circ W$   $36.10$  ch. E. S. E.  
to Eq.